

PERMITTED

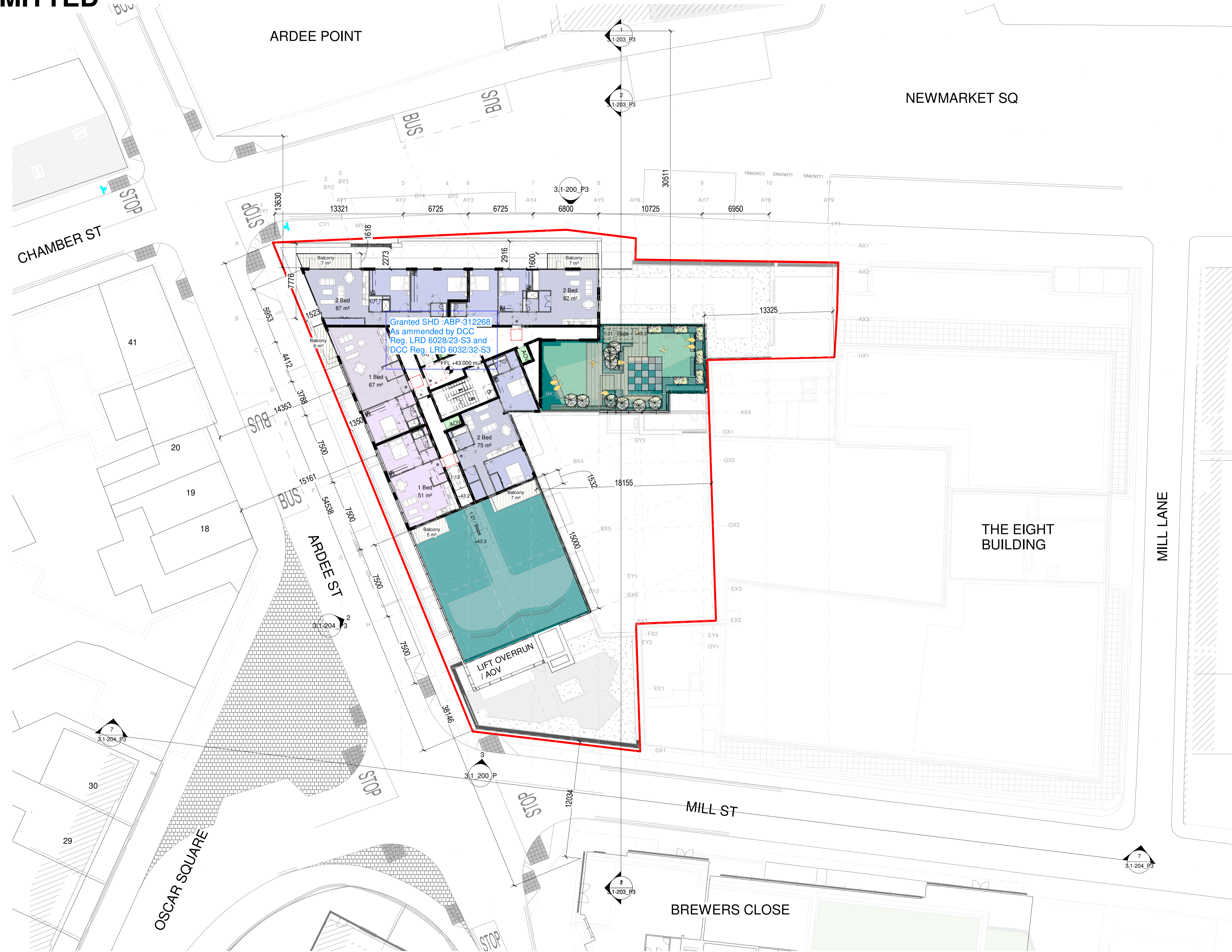

9th Floor Plan - Permitted
1 : 200

Notes:
DO NOT SCALE FROM THIS DRAWING. USE FIGURED DIMENSIONS IN ALL CASES. VERIFY DIMENSIONS ON SITE AND REPORT ANY DISCREPANCIES TO THE ARCHITECTS IMMEDIATELY. THIS DRAWING TO BE READ IN CONJUNCTION WITH THE ARCHITECTS SPECIFICATION. © THIS DRAWING IS COPYRIGHT AND MAY ONLY BE REPRODUCED WITH THE ARCHITECTS PERMISSION.

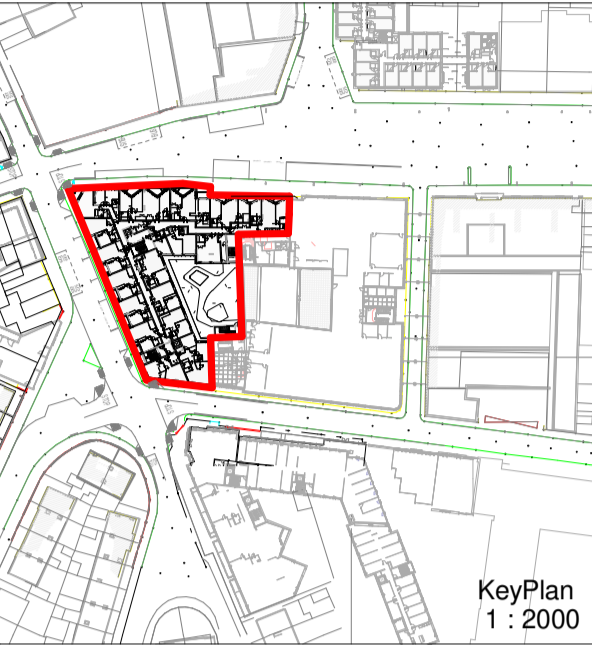
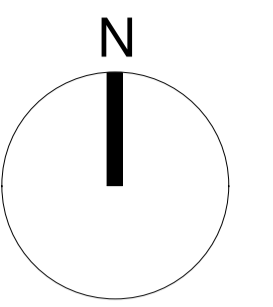

PLANNING LEGEND

- Site Boundary Line
- Proposed Amendments

- Studio
- 1 Bed
- 2 Bed
- 2 Bed (4)
- 3 Bed
- 2 Bed (3)
- Amenity
- Bicycle Parking
- Bikes
- Co-Working
- Core
- Commercial
- Energy Centre
- Games Room
- Foyer
- Plant
- Refuse
- Sub/Switch

P-02	19.08.24	EOB	ISSUED FOR PLANNING
P-01	29.07.24	EOB	ISSUED FOR PLANNING

Rev	Date	DRN	Description
-----	------	-----	-------------

Reddy Architecture + Urbanism
Darryl Mills,
Darryl Road,
Dublin 6, D06 Y0E3.
T: +353 (0)1 4887000
W: www.reddyarchitecture.com
E: info@reddyarchitecture.com

Client Details:
NREK1 Limited

Project Details:
Ardee Street
18 Newmarket, Dublin 8

Drawing Title:
Permitted 9th Floor Plan

Job No	Date	Scale@A1
P19-149D	19.08.24	1:200

Status	Drawn By:
Planning	LH

Purpose	Checked By:
	EOB

Drawing Number	Revision
P19-149D-3.1-109_Pt	P-02