

PROPOSED

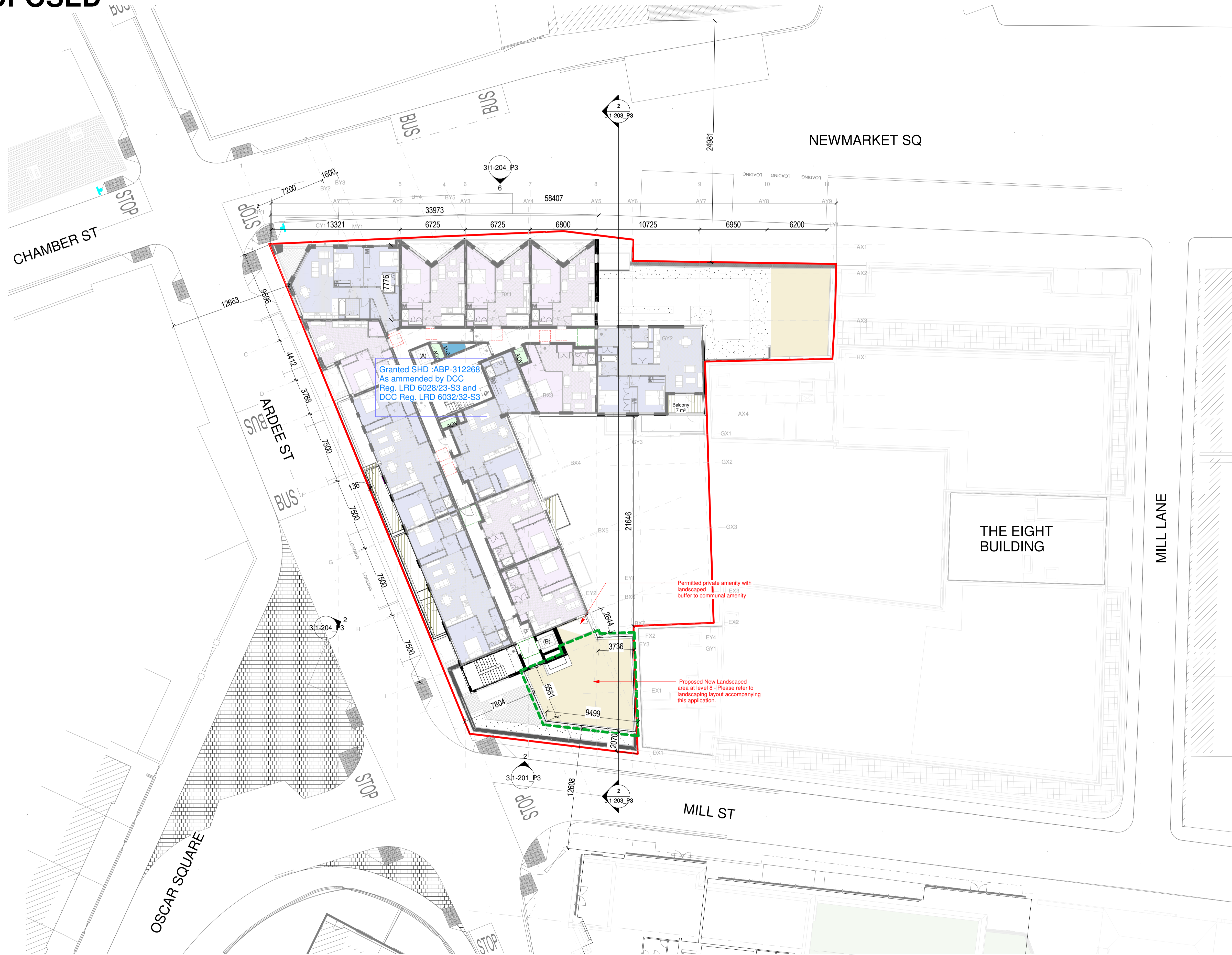

Granted SHD :ABP-312268
As amended by DCC
Reg. LRD 6028/23-S3 and
DCC Reg. LRD 6032/32-S3

Permitted private amenity with landscaped buffer to communal amenity

Proposed New Landscaped area at level 8 - Please refer to landscaping layout accompanying this application.

Notes:
DO NOT SCALE FROM THIS DRAWING. USE FIGURED DIMENSIONS IN ALL CASES. VERIFY DIMENSIONS ON SITE AND REPORT ANY DISCREPANCIES TO THE ARCHITECTS IMMEDIATELY. THIS DRAWING TO BE READ IN CONJUNCTION WITH THE ARCHITECTS SPECIFICATION. © THIS DRAWING IS COPYRIGHT AND MAY ONLY BE REPRODUCED WITH THE ARCHITECTS PERMISSION.

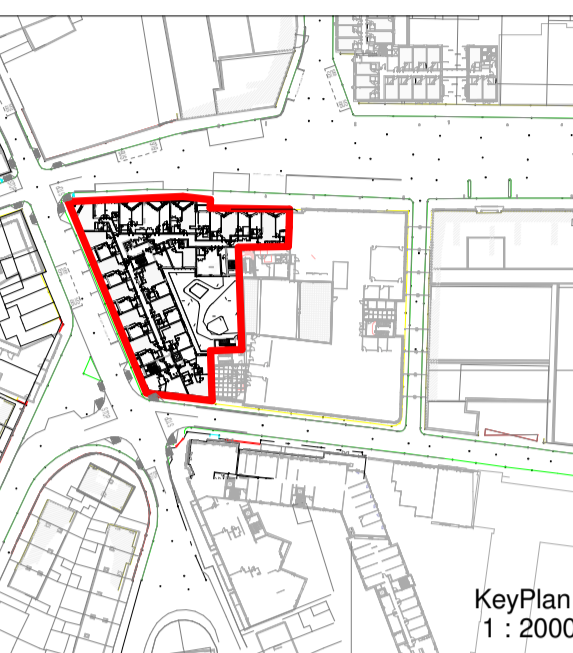
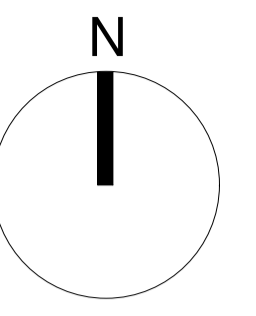

PLANNING LEGEND

- Site Boundary Line
- - - Proposed Amendments
- Studio
- 1 Bed
- 2 Bed
- 2 Bed (4)
- 3 Bed
- 2 Bed (3)
- Amenity
- Bicycle Parking
- Bikes
- Co-Working
- Core
- Commercial
- Energy Centre
- Games Room
- Foyer
- Plant
- Refuse
- Sub/Switch

01 - Proposed New Landscaped area at level 8 - Please refer to landscaping layout accompanying this application.

P-02	19.08.24	EOB	ISSUED FOR PLANNING
P-01	29.07.24	EOB	ISSUED FOR PLANNING

Rev	Date	DRN	Description
-----	------	-----	-------------

Reddy Architecture + Urbanism
Darryl Mills,
Darryl Road,
Dublin 6, D06 Y0E3.
T: +353 (0)1 4887000
W: www.reddyarchitecture.com
E: info@reddyarchitecture.com

Client Details:
NREK1 Limited

Project Details:
Ardee Street
18 Newmarket, Dublin 8

Drawing Title:
Proposed 8th Floor Plan

Job No	Date	Scale@A1
P19-149D	19.08.24	1:200

Status	Drawn By:
Planning	LH

Purpose	Checked By:
	EOB

Drawing Number	Revision
P19-149D-3.1-108_P3	P-02