

PERMITTED

ARDEE POINT

NEWMARKET SQ

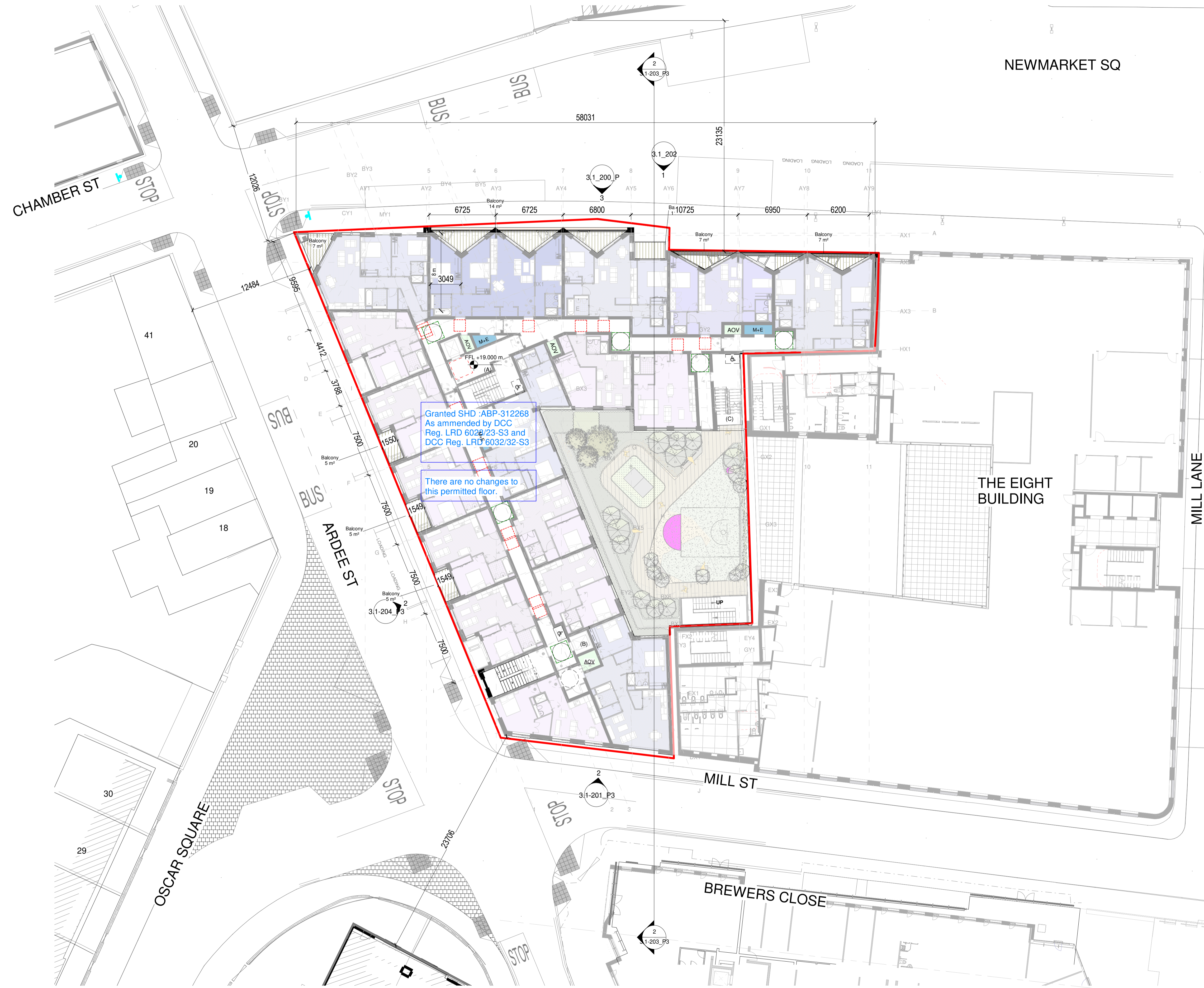

Granted SHD: ABP-312268
As amended by DCC
Reg. LRD 6022/23-S3 and
DCC Reg. LRD 6032/32-S3

There are no changes to
this permitted floor.

Notes:
DO NOT SCALE FROM THIS DRAWING. USE FIGURED DIMENSIONS IN ALL CASES. VERIFY DIMENSIONS ON SITE AND REPORT ANY DISCREPANCIES TO THE ARCHITECTS IMMEDIATELY. THIS DRAWING IS TO BE READ IN CONJUNCTION WITH THE ARCHITECTS SPECIFICATION. © THIS DRAWING IS COPYRIGHT AND MAY ONLY BE REPRODUCED WITH THE ARCHITECTS PERMISSION.

OSI License Number - AR 005219
Projection / Spatial Reference:
Projection: IRENE199_3m_Transverse_Mercator
Centre Point Coordinates:
X,Y: 715523.1581734478,1383
Reference Grid:
Map Series / Map Sheets
1:1,000 | 3283-09
1:1,000 | 3284-06
1:1,000 | 3283-04
1:1,000 | 3284-01
1:1,000 | 3283-05
1:1,000 | 3283-10
Vertical Datum:
MILLIM HEAD

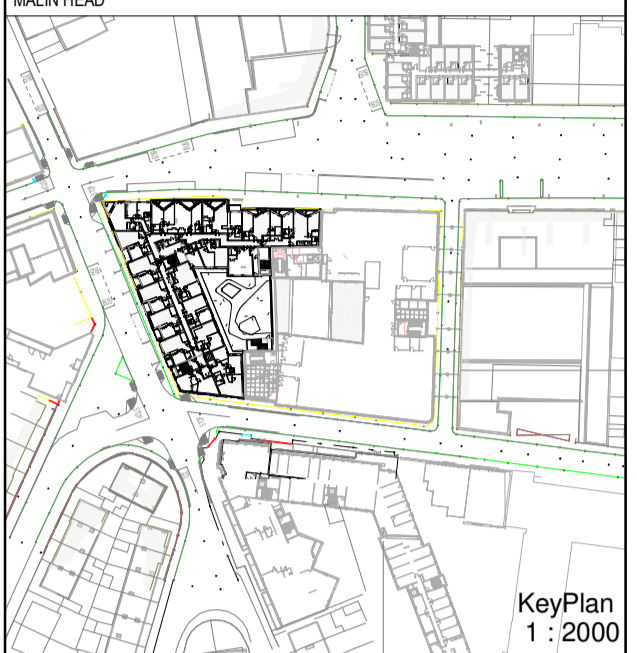
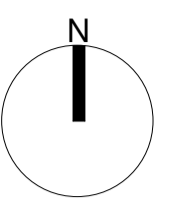

PLANNING LEGEND

- Site Boundary
- - - Amendments to Permitted scheme outlined
- Studio in green
- 1 Bed
- 2 Bed
- 2 Bed (4)
- 3 Bed
- 2 Bed (3)
- Amenity
- Bicycle Parking
- Bikes
- Co-Working
- Core
- Commercial
- Energy Centre
- Games Room
- Foyer
- Plant
- Refuse
- Sub/Switch

P-02	19.08.24	EOB	ISSUED FOR PLANNING
P01	10.02.03	EOB	ISSUED FOR PLANNING

Rev	Date	DRN	Description
-----	------	-----	-------------

Reddy Architecture + Urbanism
Darryl Mills,
Darryl Road,
Dublin 6, D06 Y0E3,
T: +353 (0)1 4887000
W: www.reddyarchitecture.com
E: info@reddyarchitecture.com

Client Details:
NREK1 Limited

Project Details:
Ardee Street
18 Newmarket, Dublin 8

Drawing Title:
Permitted 1st Floor Plan

Job No	Date	Scale@A1
P19-149D	19.08.24	1:200
Status	Drawn By:	EOB
Purpose	Checked By:	EOB

Drawing Number	Revision
P19-149D-3.1-101_P1	P-02