

**NEWMARKET, ARDEE STREET BTR
DEVELOPMENT**

HOMAN O'BRIEN
Engineering Excellence.

Public Lighting Stage 2 Submission

Project Ref.	Document Title	Rev	Prepared by:	Issue Date	Approved by:
No. 2102	Public Lighting Stage 2 Submission	01	HB	19/05/2023	AC

CONTENTS

1 Introduction..... 3

 1.1 Taking in Charge Area..... 3

2 Proposed lighting details 4

 2.1 Luminaires 4

 2.2 Lighting Columns 4

 2.3 Ducting and chambers..... 4

3 Power and circuiting 4

Appendix..... 5

1 Introduction

The proposed development consists of the demolition of all existing structures on site (approx. 0.19 ha site area) and the construction of a mixed use building ground floor commercial/retail space and build-to-rent(BTR) apartment units on the upper floors. As granted by ABP under ABP Ref. ABP-312268-21.

This report outlines the additional information requested for Stage 2 approval of purposed public lighting works to the boundary of the development.

1.1 Taking in Charge Area.

The below layout outlines the take in charge area of the development. Note that internal courtyard at first floor level and roof gardens within the development will not be taken in charge by the council now or in the future.

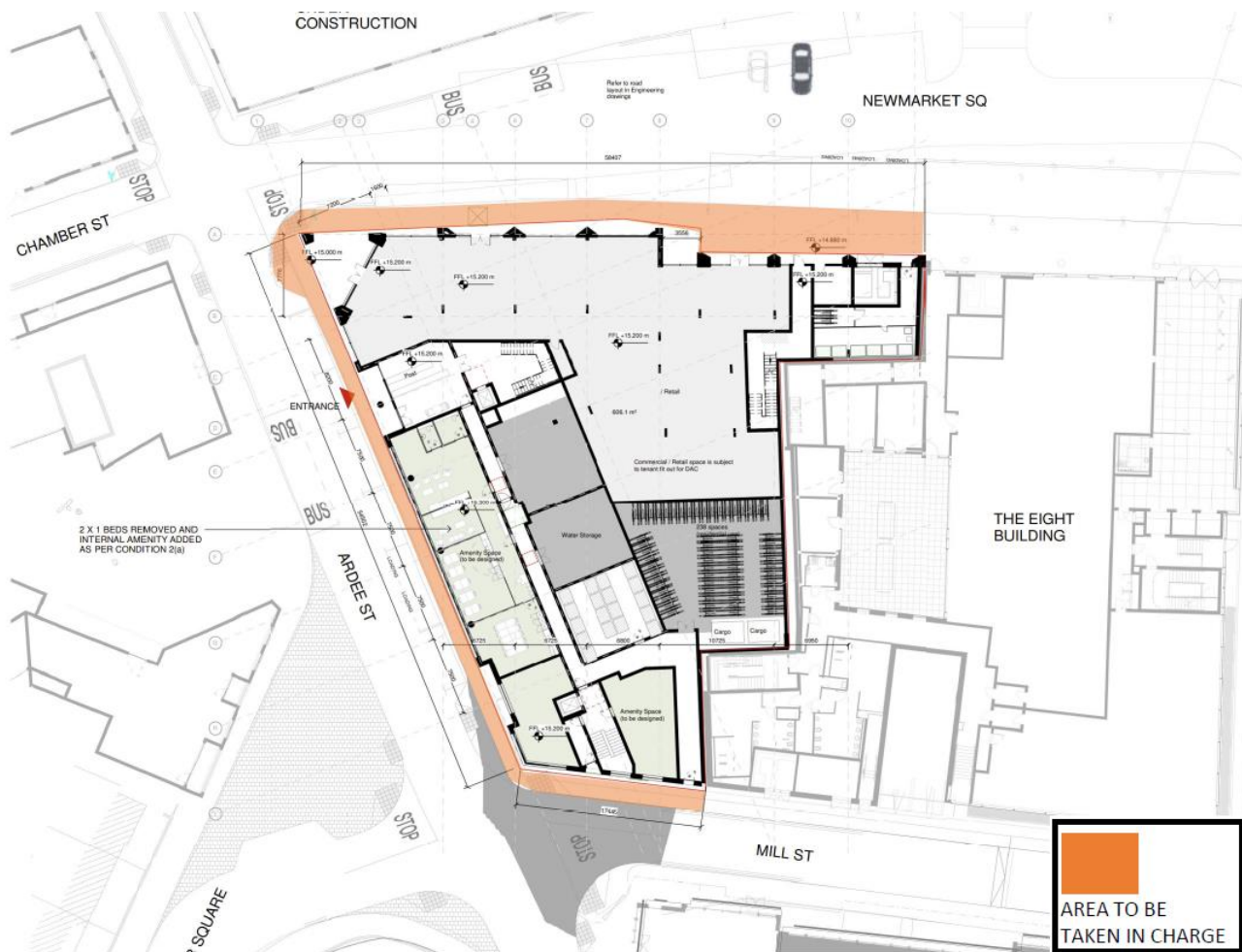

Figure 1 - Taken in charge area

2 Proposed lighting details

2.1 Luminaires

Proposed luminaires Thorn Isaro Pro 96275919 IP 12L70 740 EWR M BS 3550 CL2 M60 ANT
Refer to Appendix 3. Lighting Calculation Page 4-5.

2.2 Lighting Columns

Proposed column Veelite Octagonal Pole Series 6m 5PBRG0600
Refer to Appendix 3. Lighting Calculation Page 6-7.

2.3 Ducting and chambers

Refer to layout 2102-E1000 which indicates proposed ducting and chambers. Ducting and chambers will be in compliance with General Specification for residential developments. The ducting will be Single wall ducting, colour red, manufactured from high density polyethylene (H.D.P.E.), 107mm external diameter, having a wall thickness of 5mm. This ducting will have the words "Public Lighting" stamped on, letter size 9mm at 1m intervals. The lettering to face uppermost in the trench. All works will be to Local Authority specification. Ducts will be routed under footpaths as indicated on layouts. JB1 Cable chambers will be provided as indicated on layouts.

3 Power and circuiting

It is proposed to provide a new public lighting mini pillar adjacent the new ESB substation for the development as indicated on the layouts to supply the new public lighting. The cable type will be 2X6sq PVC/SWA/PVC Cable plus integral earth laid in ducting to I.S.10101:2020. Refer to Appendix 3. Lighting Calculation Page 8 for circuit schematic.

Appendix

Below drawings and documents included in appendix

- 1) Site layout plan P19-149D_3.1_004 – Site location map with site boundary.
- 2) Taking in charge area.
- 3) Lighting Calculation
- 4) 2102-E1000 – Site lighting layout
- 5) 2102-E1001 – Site lighting layout c/w isolines